

friday morning drive to Quitman

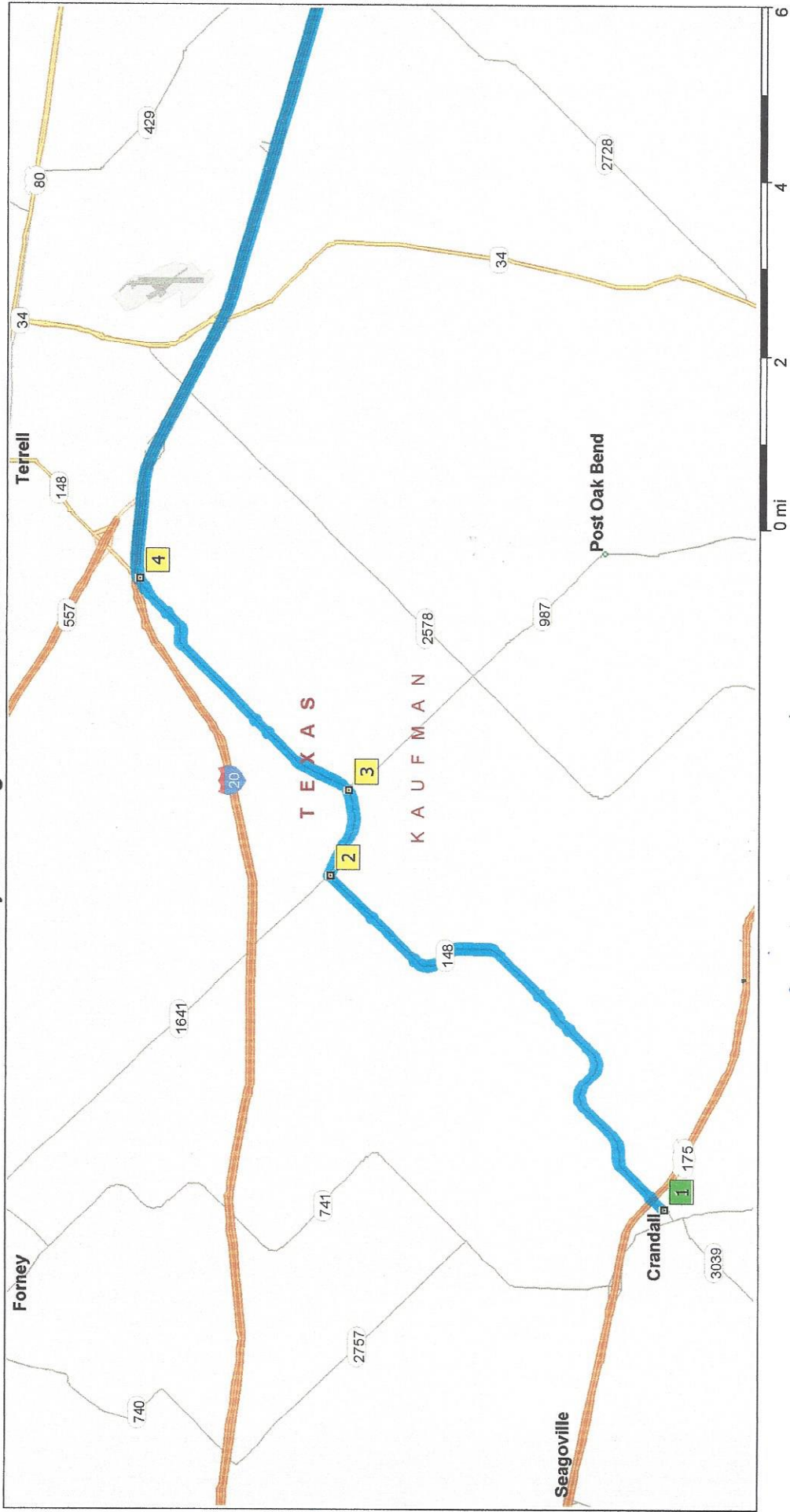

Copyright © and (P) 1988-2007 Microsoft Corporation and/or its suppliers. All rights reserved. <http://www.microsoft.com/streets/>
Certain mapping and direction data © 2007 NAVTEQ. All rights reserved. The Data for areas of Canada includes information taken with permission from Canadian authorities, including © Her Majesty the Queen in Right of Canada, © Queen's Printer for Ontario, NAVTEQ and NAVTEQ ON BOARD are trademarks of NAVTEQ. © 2007 Tele Atlas North America, Inc. All rights reserved. Tele Atlas and Tele Atlas North America are trademarks of Tele Atlas, Inc.

friday morning drive to Quitman



friday morning drive to Quitman

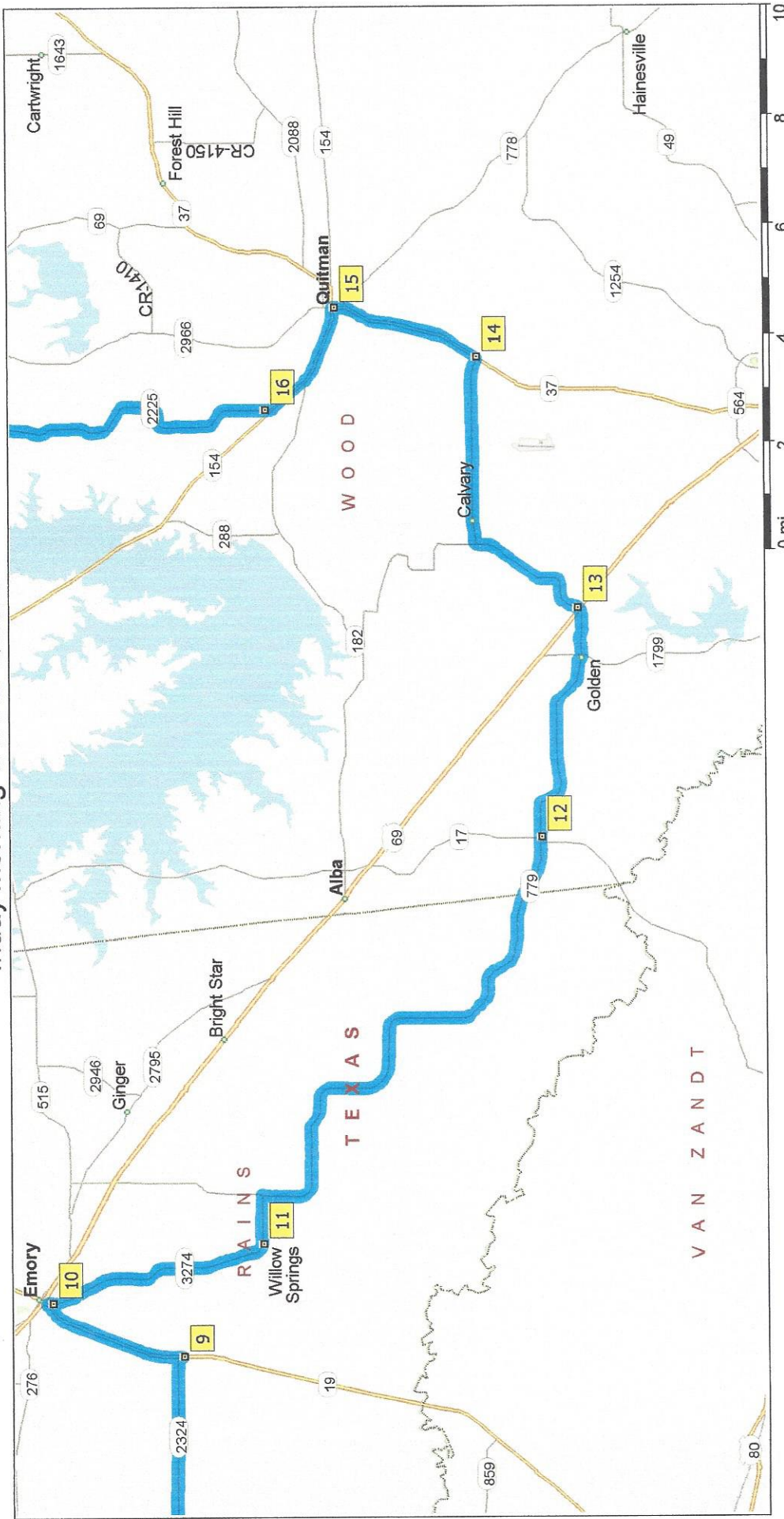

friday morning drive to Quitman

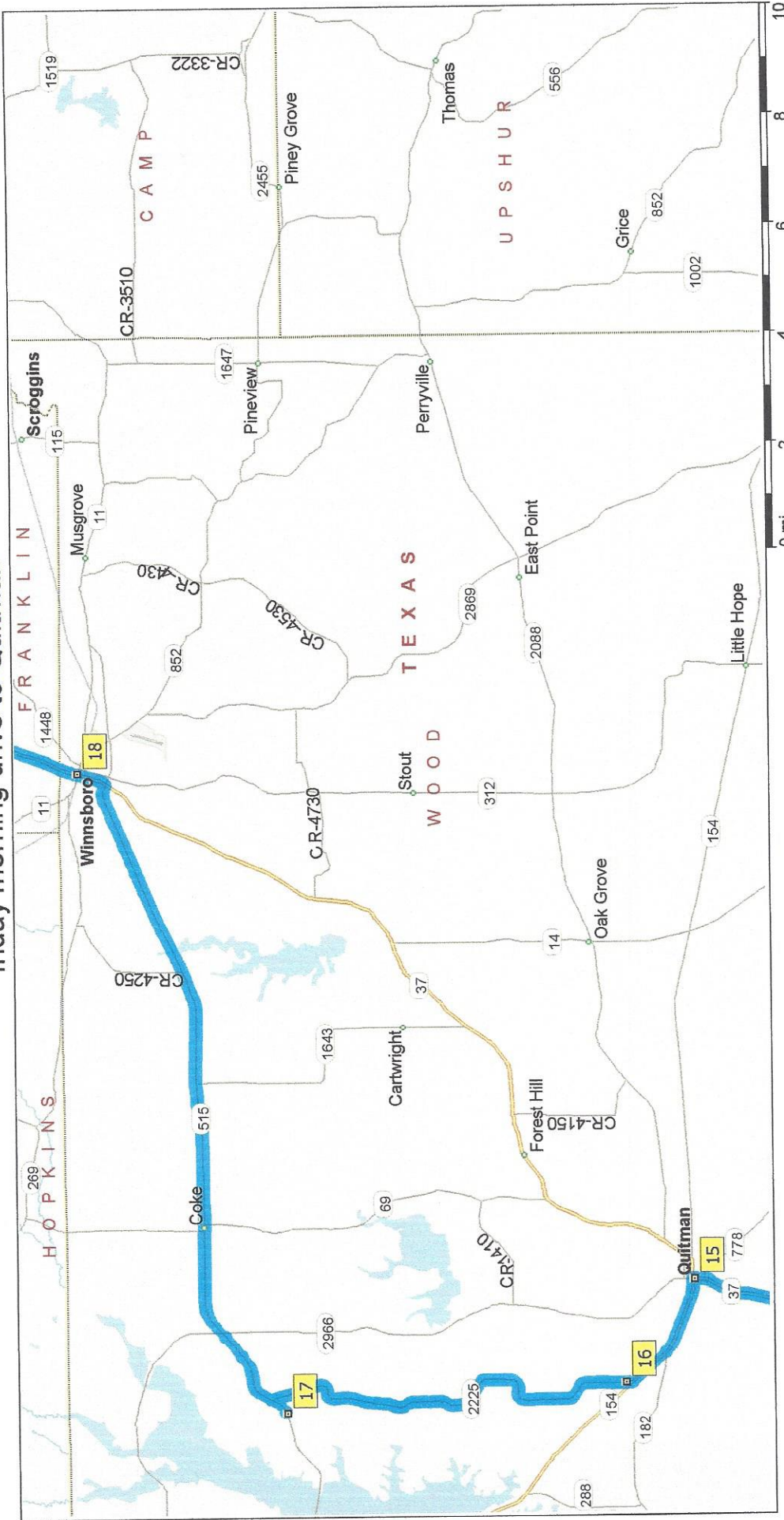

mt. Pleasant
 friday morning drive to **Quitman**

to MICH Bldg.

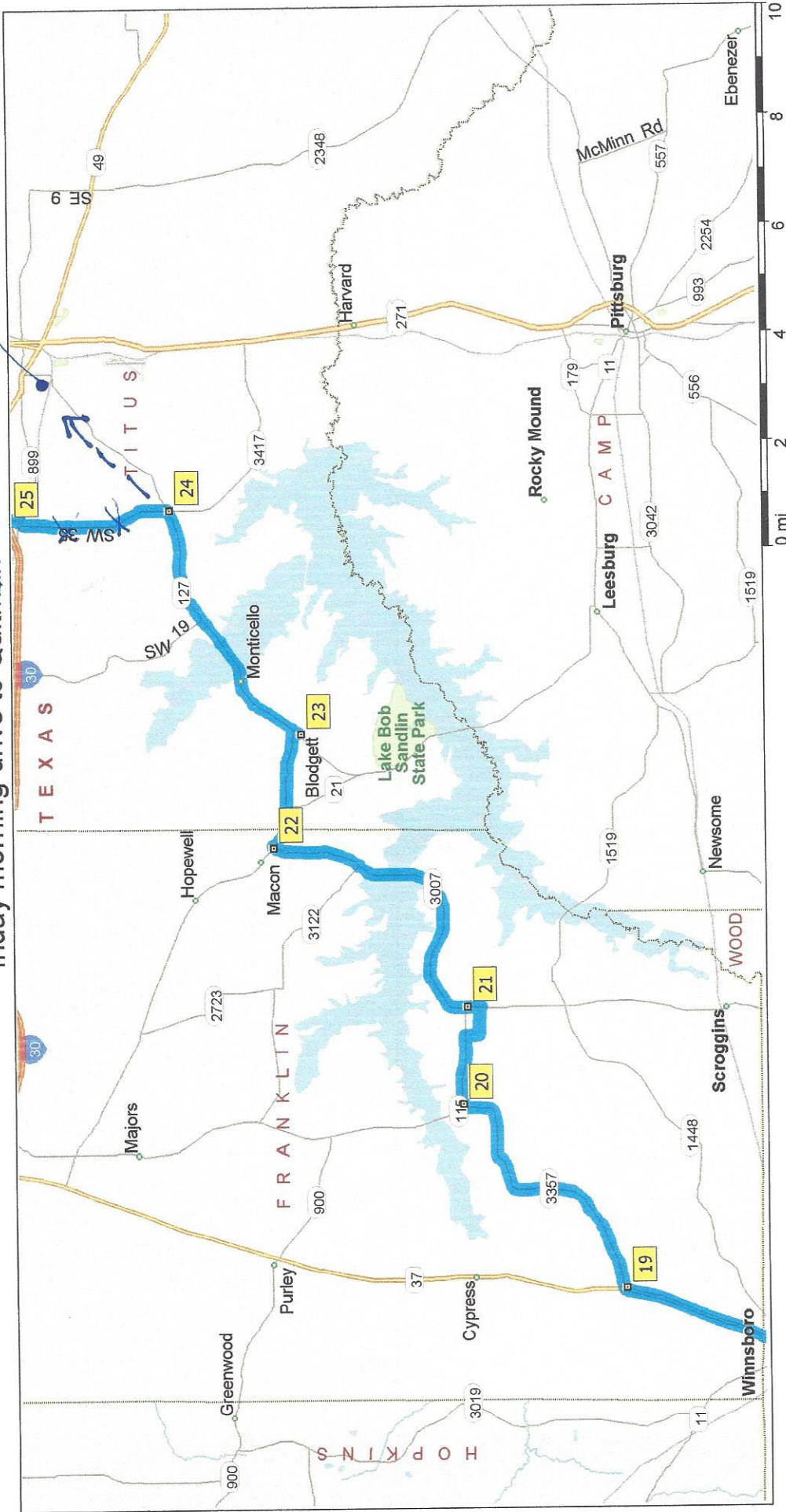

mt. pleasant

friday morning drive to ~~Quintan~~

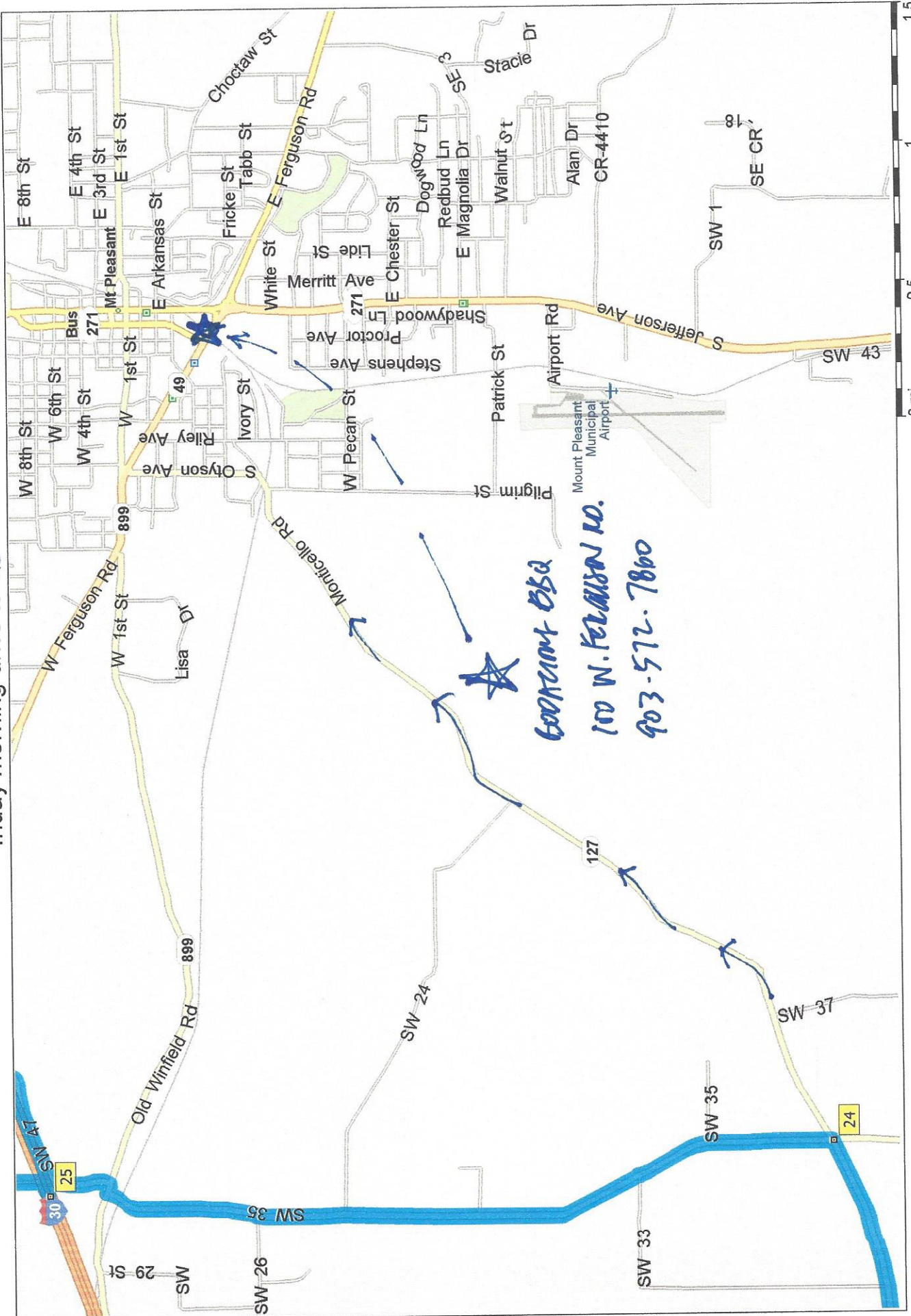

600 ACACOM BSA
100 W. FERGUSON RD.
903-572-7800

AFTERNOON *HOME*
 friday morning drive to Quitman

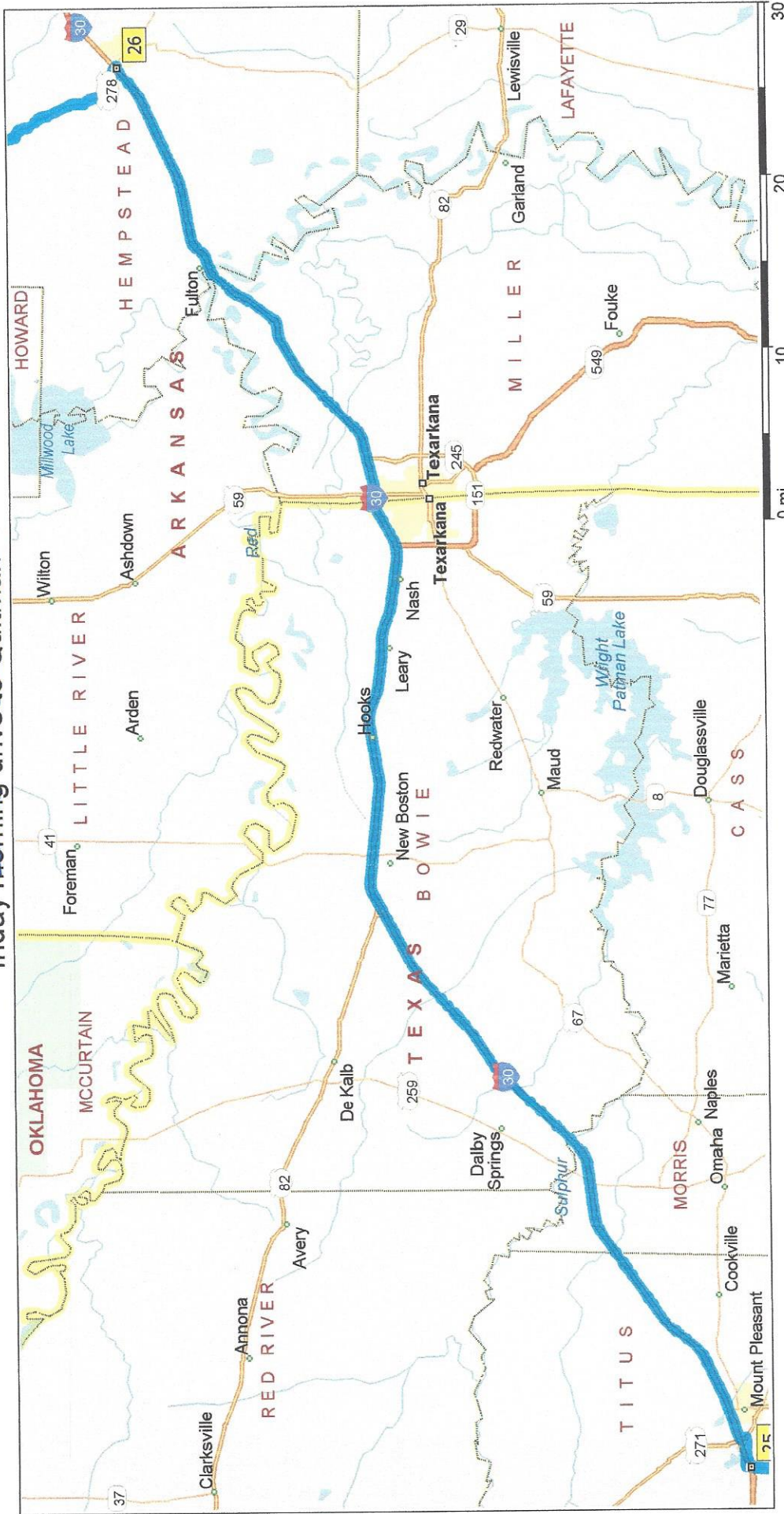

Copyright © and (P) 1988–2007 Microsoft Corporation and/or its suppliers. All rights reserved. <http://www.microsoft.com/streets/>
 Certain mapping and direction data © 2007 NAVTEQ. All rights reserved. The Data for areas of Canada includes information taken with permission from Canadian authorities, including: © Her Majesty the Queen in Right of Canada, © Queen's Printer for Ontario, NAVTEQ and NAVTEQ ON BOARD are trademarks of NAVTEQ. © 2007 Tele Atlas North America, Inc. All rights reserved. Tele Atlas and Tele Atlas North America are trademarks of Tele Atlas, Inc.

Afternoon
 Hot Springs
 Friday morning drive to Guitman

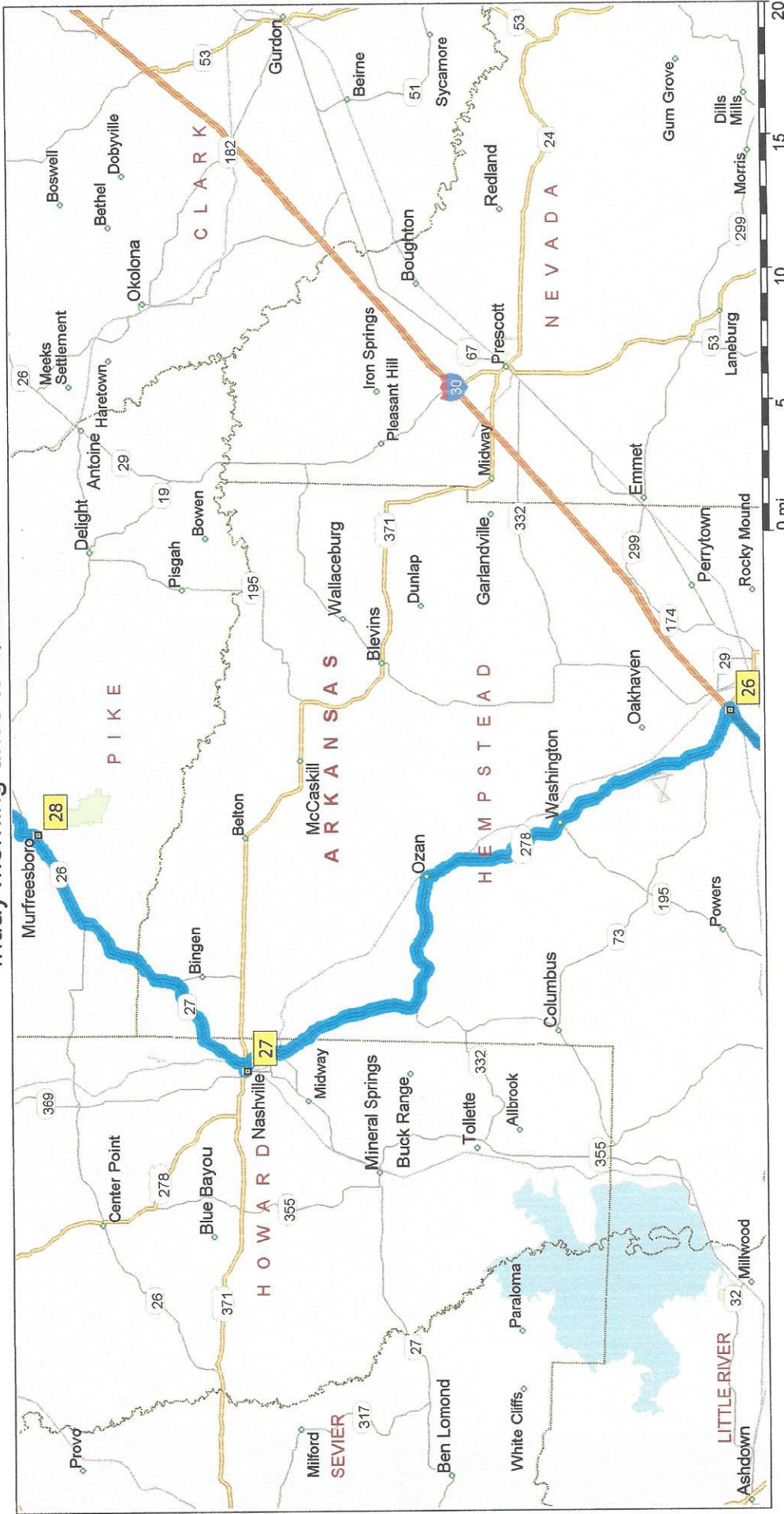

Copyright © and (P) 1988-2007 Microsoft Corporation and/or its suppliers. All rights reserved. <http://www.microsoft.com/streets/>
 Certain mapping and direction data © 2007 NAVTEQ. All rights reserved. The Data for areas of Canada includes information taken with permission from Canadian authorities, including: © Her Majesty the Queen in Right of Canada, © Queen's Printer for Ontario, NAVTEQ and NAVTEQ ON BOARD are trademarks of NAVTEQ. © 2007 Tele Atlas North America, Inc. All rights reserved. Tele Atlas and Tele Atlas North America are trademarks of Tele Atlas, Inc.

